

Thrive Hearing Control Application

Android | Advanced

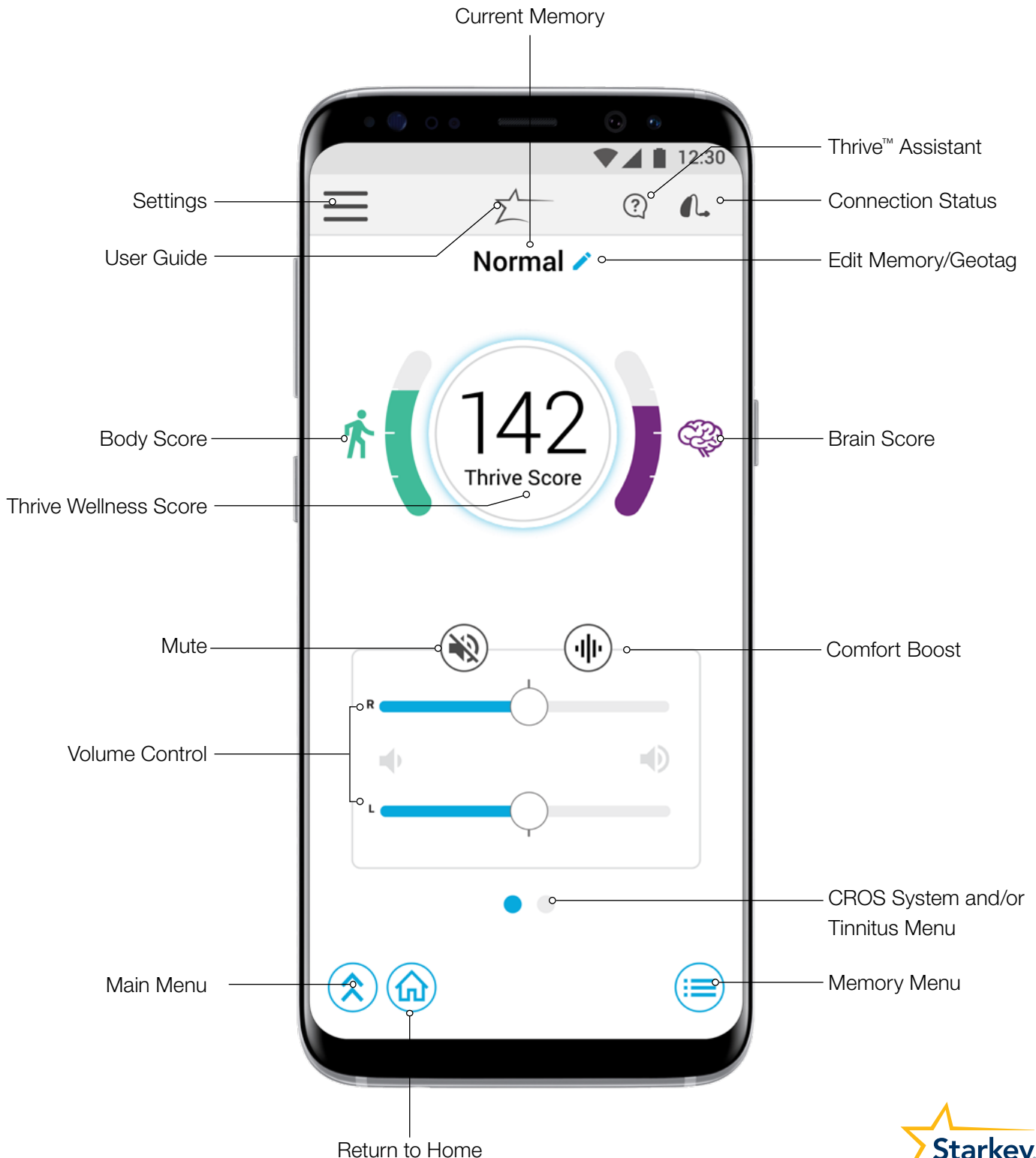

Hearing Aid Memories

Create a New Memory

Select the memory that provides the best sound quality for the current listening environment. Selected memory is the baseline for adjustments.

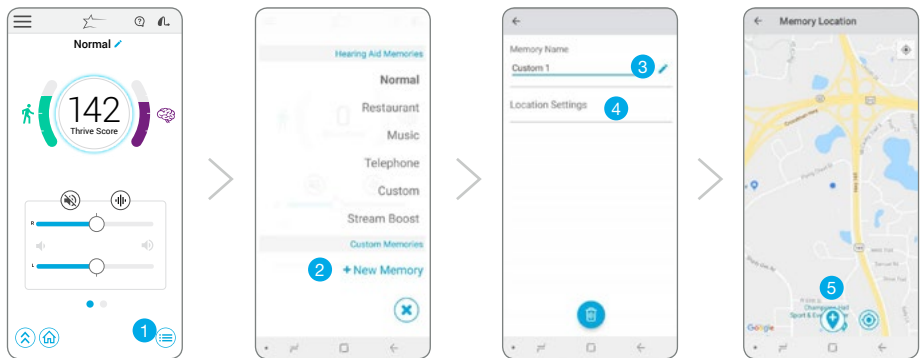

To create a custom memory, go to:

- 1 **Memory Menu**
- 2 **+ New Memory**
- 3 **Memory Name**
- 4 **Location Settings**
- 5 **Set Location:** Pin sets to current location. Tap (bottom of the map) to assign a geotag.

“Temp” Any adjustment to a memory that was set by the hearing professional in Inspire™ X will automatically save as “Temp”. Tap to name and save in the custom memories list for future use.

Smart VC Volume position is saved and set for custom memories to provide a more consistent user experience.

Customize a Memory

Several features are available for memory customization to balance comfort and clarity in different types of environments. For additional customization, choose the Main Menu and select **Customize**.

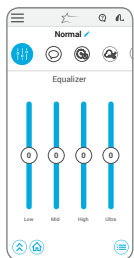

Equalizer
Adjust equalizer sliders for additional memory fine tuning.

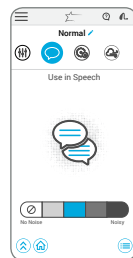

Use in Speech
Enhances speech understanding in the presence of background noise.

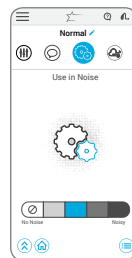

Use in Noise
Makes listening more comfortable when machine-type noise is present.

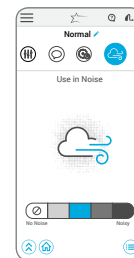

Use in Wind
Makes listening more comfortable in windy areas.

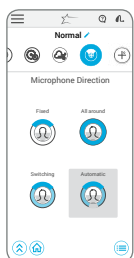

Microphone Direction
Adjust where the microphones pick up sounds. Tap the icon to choose:

Front
Amplifies sound from in front of the listener more than from behind.

All Around
Amplifies sound from all directions equally.

Switching
Automatically switches between Front and All Around based on the environment.

Automatic
Adaptive null steering to protect speech at all angles around the listener.

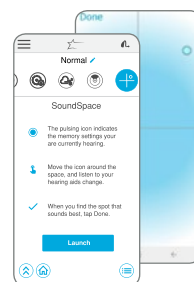

SoundSpace™
Move the pulsing icon around the screen. Real-time changes to the sound quality will be heard. Select **Done** in the top left corner of the screen once the desired sound quality is found.

Thrive Wellness Score

The Thrive Wellness Score links the importance of hearing health to physical and cognitive health through the combination of one's Body Score and Brain Score. A total daily Thrive Wellness Score of 200 points is possible.¹

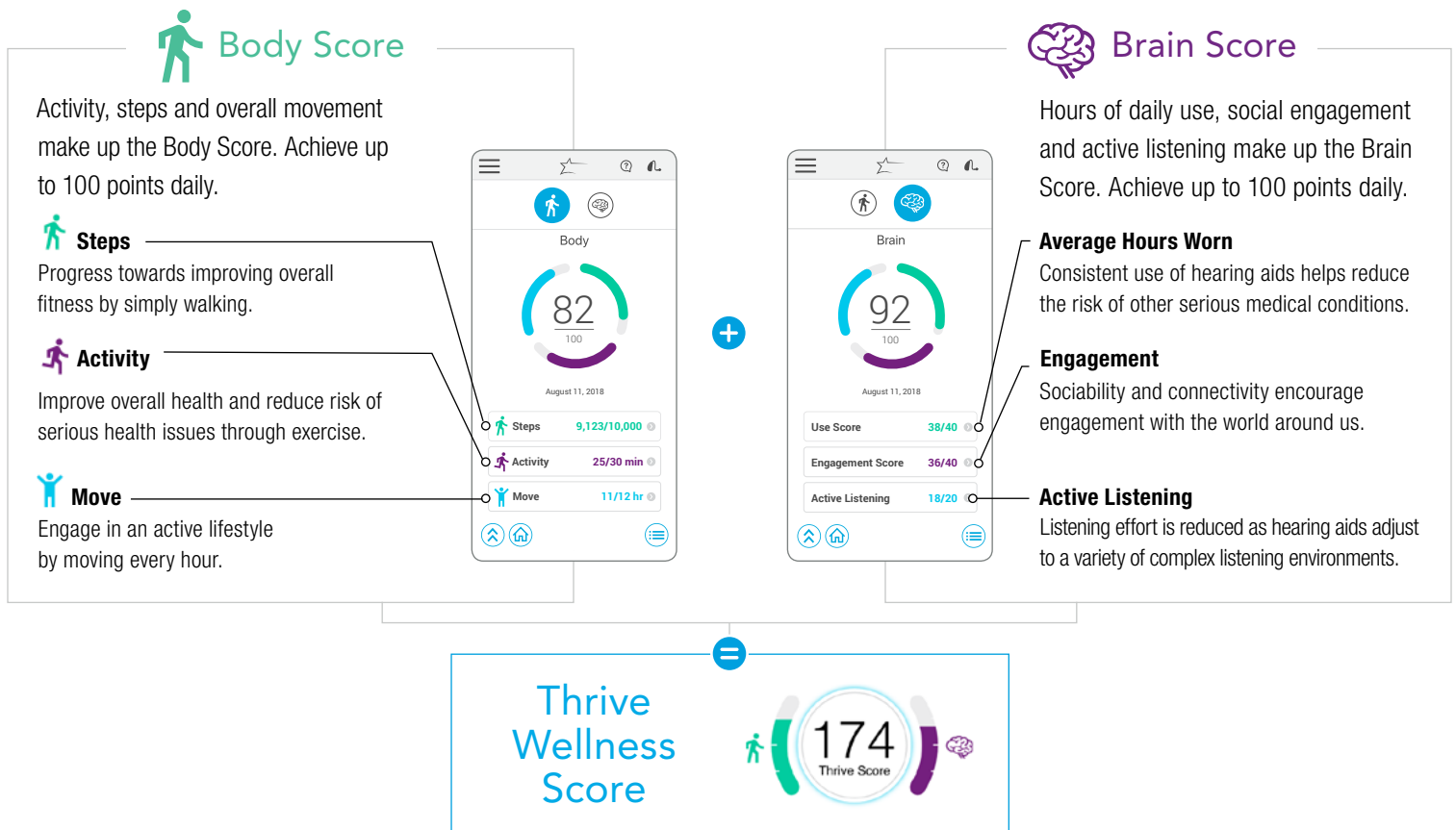

Fall Alert

The Fall Alert feature utilizes integrated sensors to automatically detect falls and send alert messages to selected contacts — helping hearing aid wearers feel secure and maintain their independence while providing peace of mind to their caregivers.

For more information, please see the [Fall Detection and Alerts Inspire X, System Setup and User Guide QuickTIPS](#).

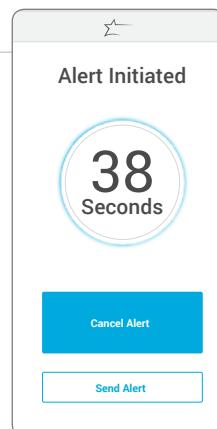

Auto Alert
A fall is automatically detected.

Manual Alert
The user control is pushed to initiate an alert.

Accessories

View paired accessories within the Thrive Hearing Control app.²

Select an Accessory to:

- Start/stop audio streaming
- Adjust volume of stream
- Adjust hearing aid microphone level while streaming
- Edit accessory name by tapping the near the accessory button
- Delete paired accessory

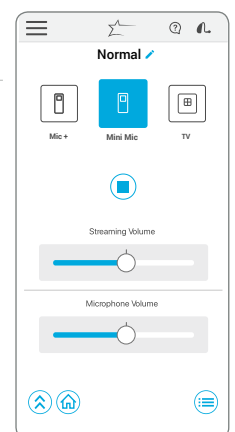

Thrive Assistant

Thrive Assistant is an app-based assistant providing hands-free help whenever and wherever needed. Users can conveniently troubleshoot hearing aid and accessory issues.

- 1 Tap the  icon in the top right corner of the Thrive app to access Thrive Assistant. All users can double tap to access Thrive Assistant if set as a user control by the hearing professional within Inspire X.
- 2 Thrive Assistant will indicate *“Listening, please ask your question.”*
- 3 State your question and Thrive Assistant will search for and return an appropriate answer from the Thrive help files or cloud-based services. With a Starkey® Hearing Technologies Remote Microphone +, audio will stream directly to the hearing aids.

For more information, please see the [Thrive Assistant QuickTIP](#).



Translate

Connects to cloud services enabling translation of one language to another

When the user speaks into the phone microphone, their language is translated and transcribed on the screen.

With a Starkey Hearing Technologies Remote Microphone +, translated audio of the foreign language response streams to the user's hearing aids.³



To access the Translate feature:

Settings > Translate

- 1 Select user's language on the left and the responder's language on the right.
- 2 Tap the microphone button . It will highlight blue.
- 3 User speaks into the phone microphone.
- 4 The user's language transcribes on the top of the screen and the responder's language transcribes on the bottom.
- 5 With a Starkey Hearing Technologies Remote Microphone +, the translated audio of the responder's speech streams to the connected hearing aids.



Transcribe

Closed Captioning for real-world situations

The Transcribe feature listens for speech in the selected language and displays the captured speech as text on the screen.

To access the Transcribe feature:

Settings > Transcribe

- 1 Choose the language you wish to capture by tapping the blue bar at the top of the screen and selecting the language.
- 2 Tap the microphone button . It will highlight blue.
- 3 Speech is captured by the phone microphone and is transcribed on the screen.
- 4 Tap the  button to save, message, copy or email the transcribed text.

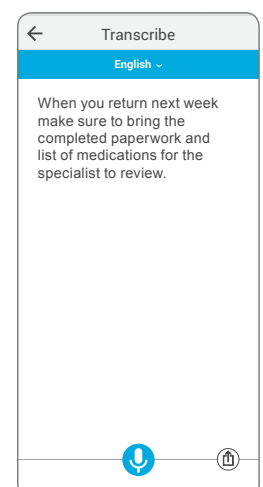

Self Check

Self Check provides a quick, convenient way for patients to analyze their hearing aid system's performance right from the Thrive app.

To access the Self Check feature:

Settings > Self Check

Select **Run Diagnostic** to initiate Self Check. Results for each hearing aid component display on the screen. Tap each component for more information.

For more information, please see the [Self Check QuickTIP](#).

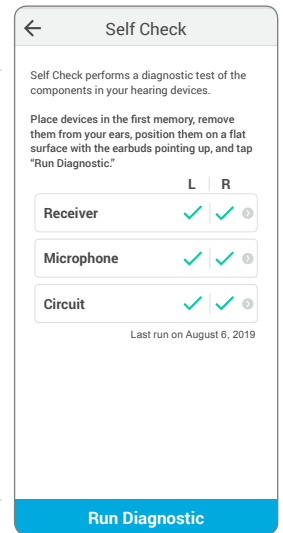

Hearing Care Anywhere

Connect remotely to a hearing professional for hearing aid programming adjustments.

Cloud-Based Services

Allows hearing aid programming information to be backed up and restored. For those who may use the Thrive app on their smartphone and tablet, cloud connectivity allows real time synchronization between these devices.

For more information, please see [Hearing Care Anywhere User Guide and QuickTip](#).

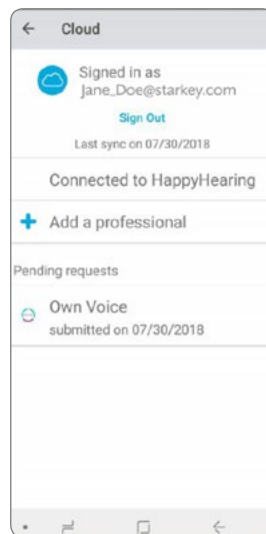

To access Hearing

Care Anywhere™ features:

Settings > Hearing Care Anywhere

- Displays sign-in status for cloud services and last sync date. Cloud connection is established when signed in, even if remote programming is not currently enabled.
- Displays a connected hearing professional or the option to add a hearing professional. Users can connect to multiple hearing professionals. View practice information for connected hearing professionals by clicking on the practice/provider name.
- Submit a new help request to a hearing professional.
- View pending help requests.

Reminders

Easily set up reminders for appointments, taking medications, prescription refills or other personal tasks. Using a SHT Remote Microphone +, hear the reminder through the hearing aids and also receive notification on the smartphone screen.

To access Reminders feature:

Settings > Reminders

- Tap **+** New Reminder.
- Select a reminder name from the pre-populated list or create your own name.
- Select preferences for the reminder such as date/time, repeating reminder and audible reminder.

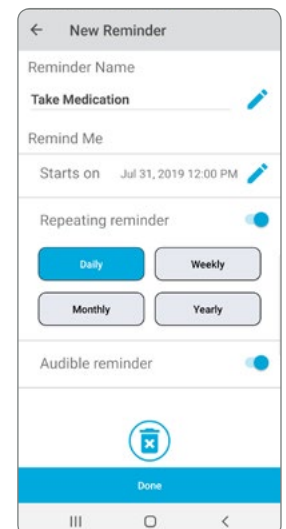

Tinnitus

Adjust the volume and modulation speed of the tinnitus stimulus in memories that have been configured for tinnitus or in custom memories based on those memories. The tinnitus screen will be visible in the Thrive app if the hearing professional has enabled the tinnitus stimulus in the active memory.

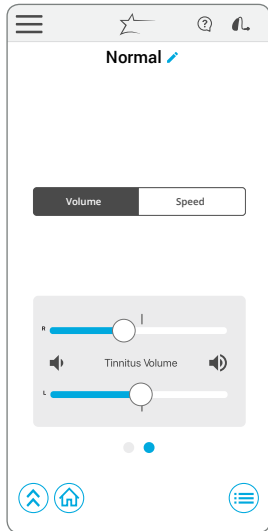

Adjusting Tinnitus Stimulus Volume

Adjust tinnitus stimulus volume individually or slide finger in the slide pad to adjust binaurally. Double tap to return to the default stimulus volume.

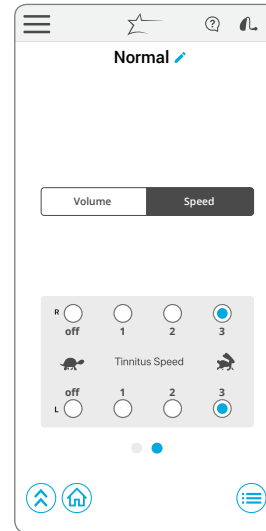

Adjusting Tinnitus Speed

Select the circle icon to adjust from no modulation to fast modulation.

CROS System

Adjust the balance of sound coming from the Transmitter relative to the Receiver in memories that have been configured for BiCROS or in custom memories based on those memories. The Balance screen will be visible in the Thrive Hearing Control app if the hearing professional has enabled BiCROS in the active memory.

- 1 Drag the circle icon along the slider to adjust the balance of sound coming from the Transmitter relative to the Receiver.
- 2 Tap **Mute Transmitter** to mute the Transmitter.

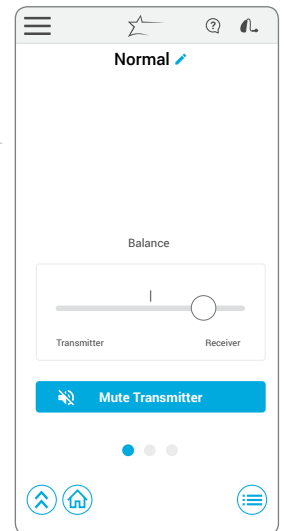

Other

In addition, Settings include:

- User Guide
- Device Settings
- Find My Hearing Aids
- About
- App Settings:
 - Demo Mode
 - Advanced/Basic Mode

Basic Mode does not include:

- Thrive Wellness Score
- Additional memory customization beyond Equalizer
- Fall Alert
- Reminders
- Transcribe
- Accessory Screen
- Hearing Care Anywhere
- Translate
- Self Check

¹Healthable® Hearing Technology only available in AI products. ²Accessories only pair to hearing aid (not to app). ³Must be connected to the internet for use.

Android and Google Play are trademarks of Google Inc.

© 2019 Starkey Hearing Technologies. All Rights Reserved. 8/19 FLYR3472-00-EE-SG-IV